

## Elegance – with patch fittings

### Panel design

The small size of the corner-mounted patch fittings ensure that the large glass surfaces are shown to their best advantage.  
Toughened glass safety panels (ESG), 10 or 12 mm.

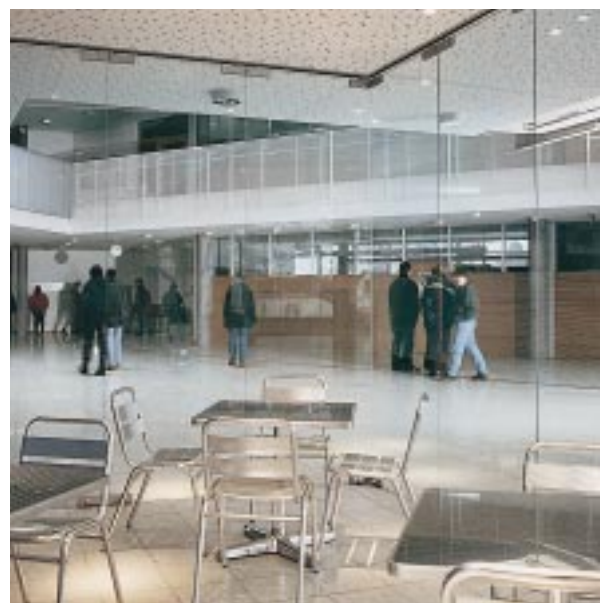
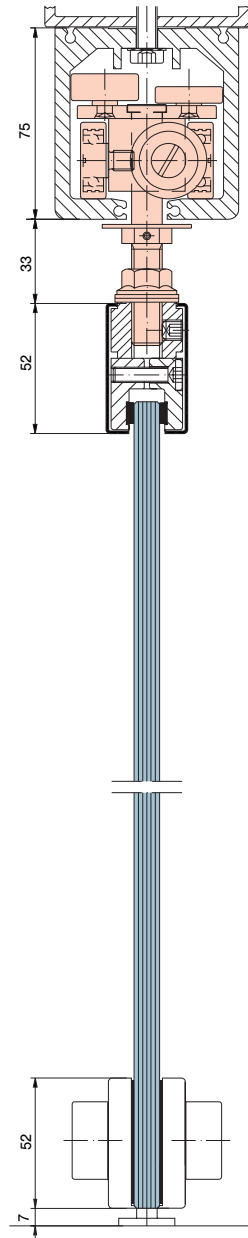

### Materials and finishes

#### Tracks and carrier profiles

- Aluminium, anodised
- Aluminium, coloured coating

#### Clip-on covers

- Aluminium, untreated
- Aluminium, silver (EV1, CO)
- Aluminium, dark bronze (DB14, MC1003, C34)
- Aluminium, white (RAL 9016)
- Aluminium, special colour finishes
- Brass, polished
- Stainless steel, satin

### Panel options and functions

- (1) Sliding panel, fixed when the shopfront is closed
- (2) End panel, non-sliding, as a double-action or single-action door

### Maximum panel sizes and weights

Panel type	Height in mm	Width in mm	Weight in kg
(1) Sliding panel	3000	1100	80
(2) End panel	3000	1100	80

 HSW-GE

